

MONUMENT RECORD
State of Indiana - County of Monroe

Section: 19

Township: 8 North

Range: 1 East

Corner ID: Sa Cr C-15

Monument Description & Remarks: Found Sandstone with "+" at center of section. Stone was wrapped in flagging and measured 1.30' (h) x 0.88' (l) x 0.37' (w).

References on file in the County Surveyor's Office: Survey in Morgan Monroe State Forest, dated March 1, 1986, prepared by Smith Quillman Associates. Legal Survey Book #2, Page 268-269.

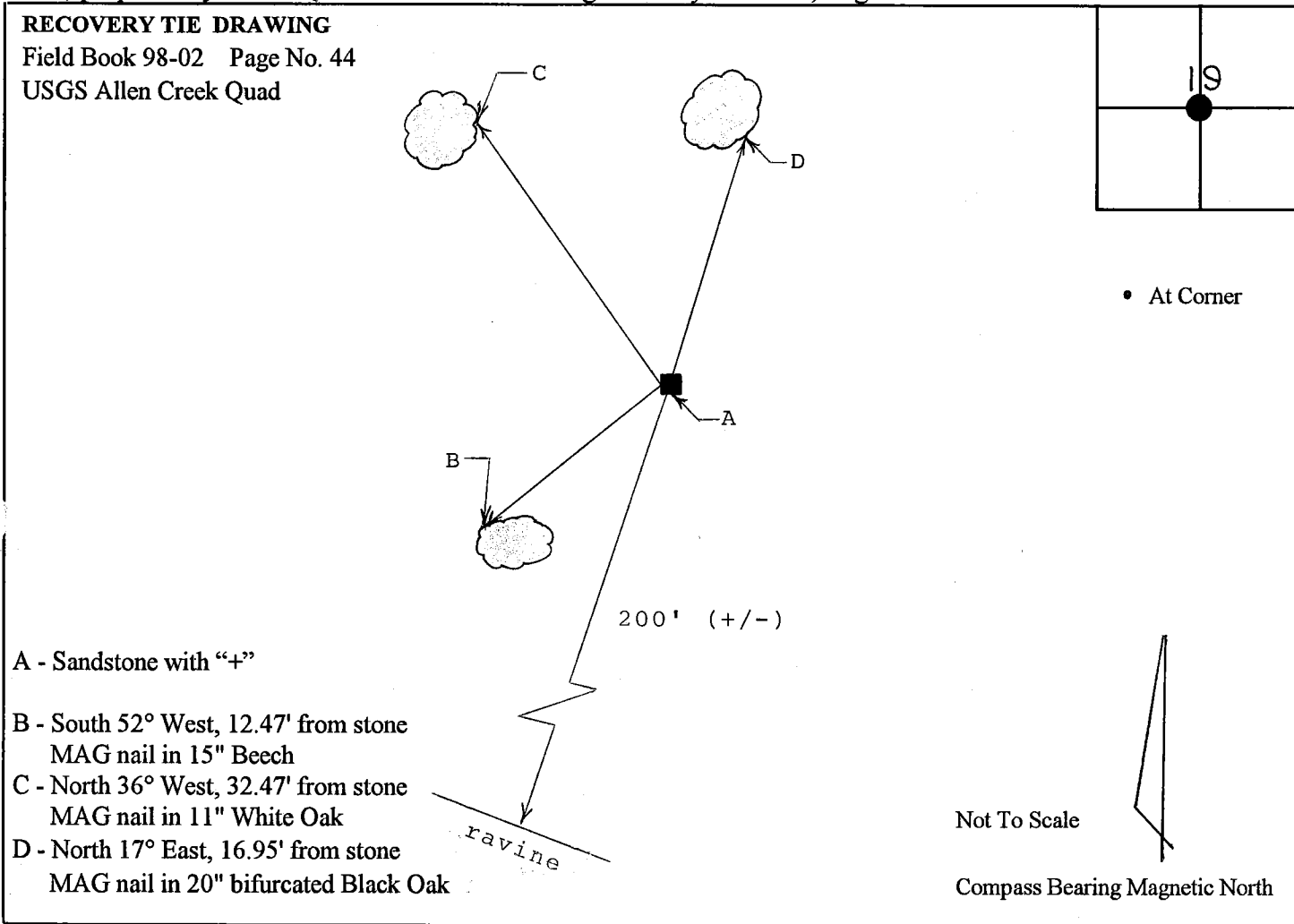

I, Kevin P. Enright, Monroe County Surveyor, hereby certify that this document was prepared under my direction in accordance with the provisions of Section 36-2-12-11 of the Indiana Code; and the above data is given under my hand and seal this 3rd day of December 1998.

Kevin P. Enright

Administered by Surveyor Review Board